

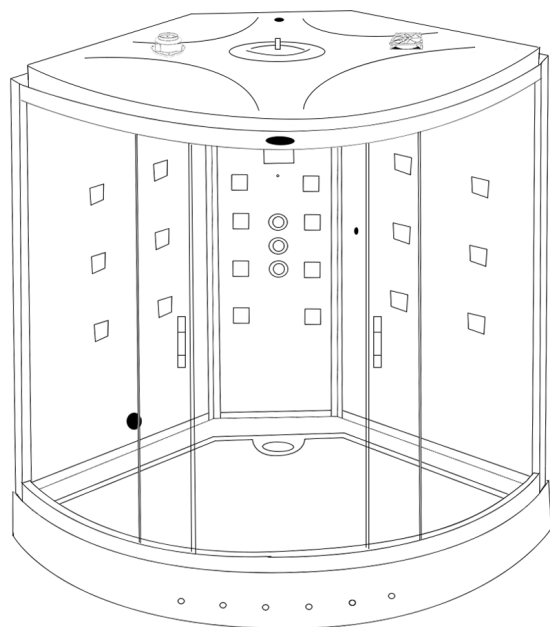

www.insigniarange.co.uk

INSTALLATION MANUAL

GT7000



30 Day Technical Support: 01908 226545

(NOTE: This service is only available to customers from the day of delivery, please have your supplier's details and your postcode to hand before calling)

Replacements Parts: inside of your warranty contact:
www.insigniarange.co.uk/customerService.aspx

Spares/Replacements Parts: outside of your warranty
contact **0844 800 3069**

ATTENTION INSTALLERS:

These instructions must be
left with the customer

WARRANTY REG NO: _____

To claim your full 5 year warranty, register your shower within 90 days of delivery at: www.insigniarange.co.uk/warrantyreg.aspx. Standard 12 month warranty applies if outside this time period.

Contents

Introduction	3
Electrical Requirements	5
What's In The Boxes?	6
Screw Pack Contents	7
Plumbing Requirements	8
Starting The Installation	9
Electric Box/Steam Generator Connections	20
Sealing and Water Testing	23
MK117 Control Panel Instructions	24
Help Book Information	25
Parts List	26



Thank you for your recent purchase of an Insignia shower. Please read this booklet with great care to ensure you get the best out of your build and have a shower that will last for many years to come!

Like everything, in order to obtain a first class product that will serve you well for many years, the effort and correctness put into the assembly will reflect in the quality of your finish.

OUR BADGE RATING IN TERMS OF DIFFICULTY OF ASSEMBLY IS BASED ON CLIENT FEEDBACK

1 Badge = Very easy

2 Badges = Easy

3 Badges = Moderate

4 Badges = Harder than average

5 Badges = Professional skills required

This shower is rated 5 Badges



ASSEMBLY AND SIMPLE PLUMBING

THIS PRODUCT BUILD IS RATED SUITABLE FOR DIY PURPOSES PROVIDING THE CUSTOMER IS OF ABOVE AVERAGE SKILLS AND FEELS CONFIDENT IN THEIR ABILITY. ONLY YOU THE CUSTOMER WILL KNOW THIS SO BEFORE ANY ATTEMPT IS MADE TO ASSEMBLY READ THROUGH THE FOLLOWING PAGES IN DETAIL THEN DECIDE. IF YOU HAVE ANY DOUBT USE THE SERVICES OF A PROFESSIONAL. IN PICKING SUCH, ALLOW THEM TO DECIDE IF THEY ARE CAPABLE OF BUILD BY FIRST SHOWING THESE INSTRUCTIONS TO THEM. ALWAYS GET THREE QUOTES.

REMEMBER THE BEST IS NOT ALWAYS THE CHEAPEST!

REMEMBER PLUMBERS PLUMB! 90% OF THIS JOB IS NOT PLUMBING!

DUE TO THE NATURE OF THIS PRODUCT WE HIGHLY ADVISE THE PURCHASE AND FITTING OF A WATER SOFTENER

ELECTRICAL CONNECTION TO HOUSE MAINS

WHEN YOUR ITEM IS ASSEMBLED ALWAYS USE THE SERVICES OF A FULLY QUALIFIED ELECTRICAL COMPANY TO COMPLETE CONNECTION FROM SHOWER TO HOUSE SUPPLY. LAWS DEMAND IN MANY CASES YOU DO THIS AND YOUR WARRANTY IS VOID REGARDS ELECTRICAL ITEMS IF THIS IS NOT UNDERTAKEN.

YOURS AND OTHERS SAFETY IS PARAMOUNT. NEVER ATTEMPT THIS YOURSELF.

REMEMBER:

These showers are designed to be free standing and movable from their location should you have need to replace anything. ALWAYS USE Flexible braided water inlet pipes at least a metre long (not central heating plastic type!)

from house supply to the shower and again flexible waste pipe to join to your house waste. NEVER fix with rigid pipes, never fix the unit to the wall.

DURING BUILD, LIKE ALL SHOWERS CORRECT SEALING IS IMPERATIVE.

ATTENTION

ALWAYS FIT EASY TO GET TO TAPS ON BOTH HOT AND COLD WATER SUPPLY. AS A DISHWASHER OR WASHING MACHINE, THIS PRODUCT MUST BE ISOLATED WHEN NOT IN USE. FLEXI SUPPLY HOSES (SUPPLIED) COUPLE HERE AS ORIGIN OF SUPPLY

YOU WILL NEED**TOTAL ELECTRICAL REQUIREMENTS**

Voltage Rating	220 -240AC
Frequency Rating	50HZ
Power Rating	4.5KW
Electric Current (Amps)	19
Specification for Wiring	AWG12 (2.05mm Diameter)

Your electrical contractor should understand **ALL** legal requirements of connection before undertaking any work or installation.

UNDER NO CIRCUMSTANCES UNDERTAKE THIS YOURSELF!!!

This product **MUST** be installed with an RCD protection trip for your safety and ensure a minor works certificate has been issued upon completion.

Always use protection against electrical surge. Your shower should be treated the same as a home computer. A surge protector should eradicate the possibility of either the transformer or computer control being burnt out.

Please Note: Earth is required and found on chassis of shower tray. A further earth is required from Steam Generator unit. Each earth must ground through power supply line.

Requirements

Scissors



Stanley Blade



Silicone Gun



Spirit Level



Tape Measure



Philips Screwdriver



Electric Drill

What's In The Boxes?

Please use the check boxes to ensure you have everything. Should you be missing a part simply call our support line on: **01908 226545** or contact us via our website www.insigniarange.co.uk/customerservice.aspx

Box 1	Check
1x Shower Tray (skirt light pre-fitted)	[]
1x Roof with Light Diffuser, Speaker & Fan	[]
2x Curved Rails	[]
1 x Screw Pack	[]
1 x Chrome Flexible Hand Shower Hose	[]
1 x Large Monsoon Shower Head	[]
1 x Hand Shower	[]
1 x White Steam Pod	[]
1 x Ozone Module	[]
1 x Black Extension Cable	[]
3 x Braided Hoses	[]
1 x Chrome Connector (water outlet for hand shower—Prefixed to right hand back wall)	[]
1 x Grey Threaded Tube and Hex Nut (attachment for monsoon shower head)	[]
1 x White insulated pipe	[]
1 x Shower Waste and Hose	[]
1 x Shower Holder (pre-fixed to right hand	[]

Box 2	Check
2 x Glass Doors	[]
2 x Side Glass	[]
2 x Door Magnets—Maybe pre-fitted to the doors	[]
2 x Plastic Door seals	[]
Approx 4 Meters of clear “U Style” seals	[]
2 x Aluminium posts	[]
2 x T-shape joining strips	[]

Box 3	Check
1x Left Hand Back Panel (steam generator fitted	[]

Box 4	Check
1x Right Hand Back Panel	[]

Box 5	Check
1x Centre Back Panel	[]

Insignia Screw Pack

Product Code	Description	Quantity
SP097 (code replaced)	Door Handles	2
SP023 (code replaced)	4 x Double wheels / 4 x Push Button double Wheels	8
ST12	12mm Screws	24
ST20	20mm Screws	8
PRC20	Securing Clips	4
BN20/N4/SW7	20mm bolt / Hex Nut / Washers	14
DB6	Drill Piece	1

VERY IMPORTANT

Have you got everything? If not please contact the Insignia Support Line on 01908 226545. Remember **NEVER** book your tradesman until everything has arrived, been checked and is present. No replacement/missing parts can be obtained free of charge during or after the build. Any claims can only be within the timescale permitted (48 hours after delivery) and always **BEFORE** build.

Pressure Requirements from your house supply

We recommend a bar pressure between 2.5 and 3.4 BAR. If you have a combi boiler system no problem should be experienced. If you have a gravity feed older type installation (hot water tank type usually less than 1 bar) you will almost certainly need a pump. We cannot advise on which type of pump is used, location or design because all house plumbing layouts vary. This is a job for your installer/plumber. The end delivery however must fall within the scope above.

Debit Requirements

You will need the debit capabilities of at least 10 litres per minute. Again an average combi boiler will supply this but please check if you have a gravity feed system.

Important Note Do not exceed 3.4 BAR pressure under any circumstances. Warranty is void if so as damage will occur. If you have a combi supply, please use a pressure reducing valve if required to lower the BAR pressure to the shower.

Please Remember that this product is free standing and is designed to be pulled away from the wall. The water supply and waste require flexible pipes. If you purchased the fitting kit with this shower you will have the required fittings. The water supply pipes need to be at least 1 metre in length and must be that of a flexi braided type..

DO NOT OVERTIGHTEN IT CAN CAUSE THE CONNECTION TO POP AFTER A FEW WEEKS OF USE

Please note if a shower pump is used via gravity system we recommend a separate cold feed bypassing pump direct to generator to avoid damage to the generator.

Further to this as you would with a washing machine or dishwasher, it is highly recommended that accessible water valve taps are installed to turn off the shower when not in use. This will avoid any possible flooding due to a burst pipe or connection failure in the future.

Whilst the next steps show you how to assemble your shower we want to make sure you have a correct build to ensure you get a trouble free shower. Therefore our advice is to follow the instructions and perform a dry run to ensure you are confident with the build and you understand fully how the unit is assembled. When we use the word "DRY RUN" this means you do not silicone anything, just simply construct the shower, align, drill and screw everything together. Once you are happy with the build take the unit apart and carry out the final fix.

TO START

Make sure you have a clear space, remember when finished and in place you need access to check your build and able to pull the shower out for servicing or should you have the need to replace anything!

Take the shower tub and remove all the protective wrapping and fit the waste. If you purchased the fitting kit it is possible this may have already been fitted in the tray hole yet please note this is only for transportation reasons therefore you will still need to ensure the correct sealing and alignment is carried out. In the side of the waste supplied in the optional fitting kit you will notice a spigot not seen on an ordinary waste. In most cases this is blanked yet should you have a steam version you need to gently drill this out as this item is for the steam generator drainage and will be connected in the instructions later.

Now please level the tray by firstly placing the tray in its final location and then using a spirit level, adjust the tray feet accordingly. Once you are happy with the levelling of the tray, you can pull it out to begin the main construction.

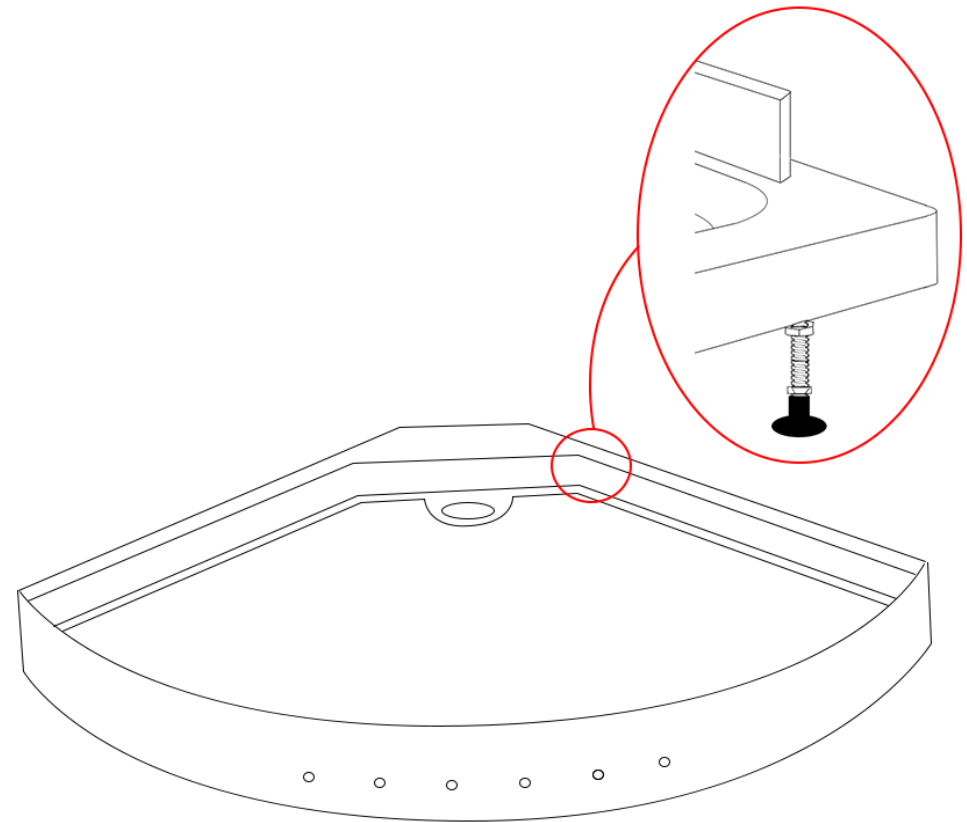

Step 1

Take the 3 back panels labelled Left, Right and Centre and attach them together as shown below. We recommend you place silicone between the panels for extra sealing and rigidity. Note the left hand panel is the panel which houses the steam outlet at the bottom of the panel.

Secure into position using the **B20/N4/SW7** bolts, washers and hex nuts as shown in the image below.

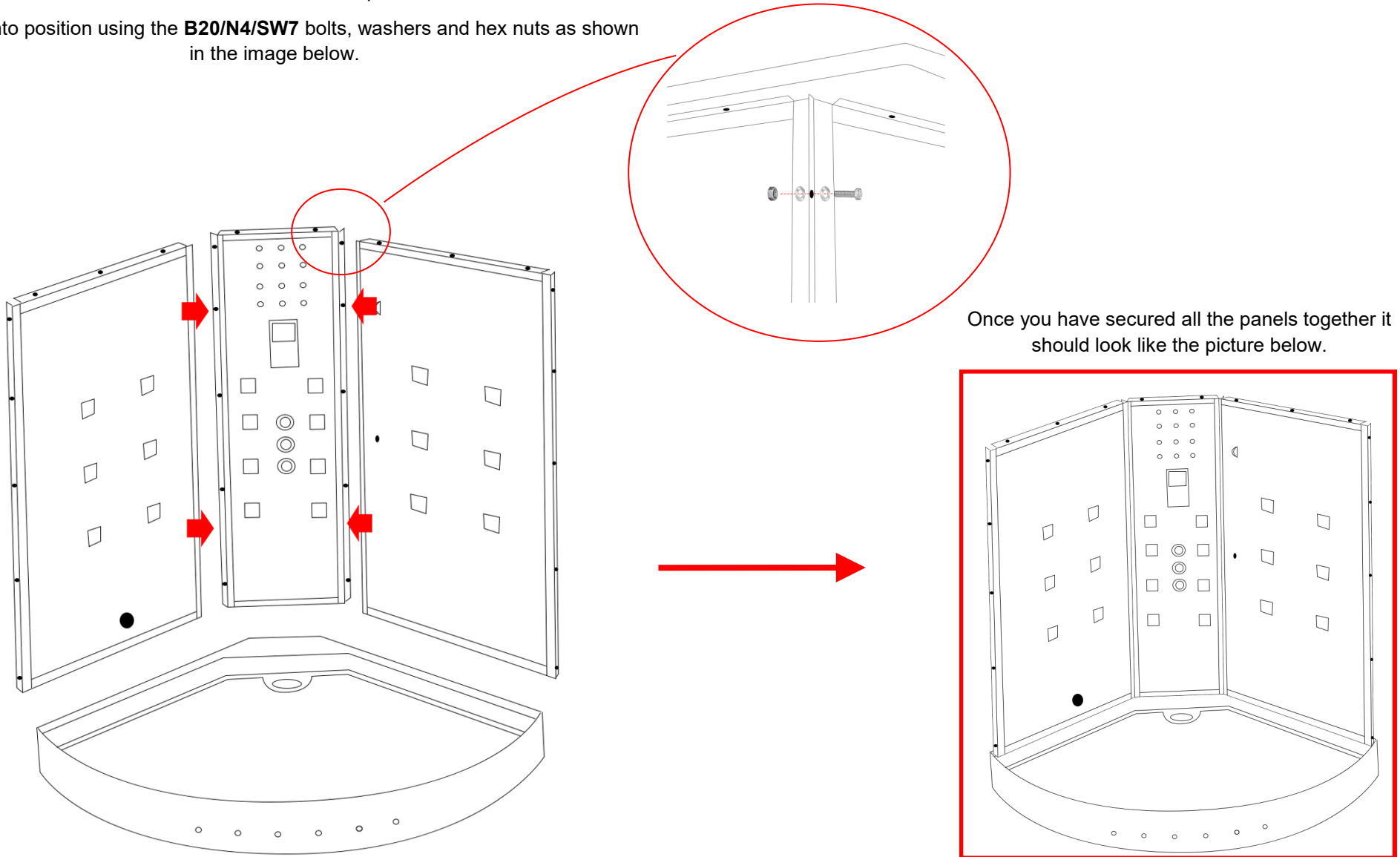

Step 2

Attach the uprights to the curved rails using the **ST20** screws
(Rail with Insignia logo at the top)

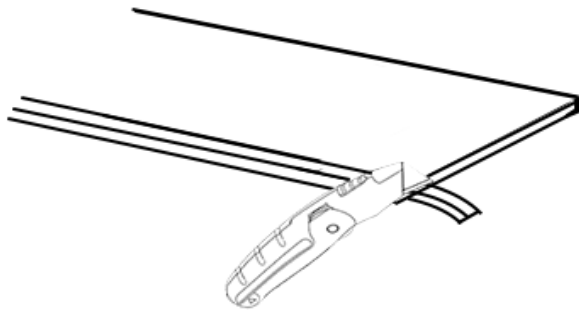
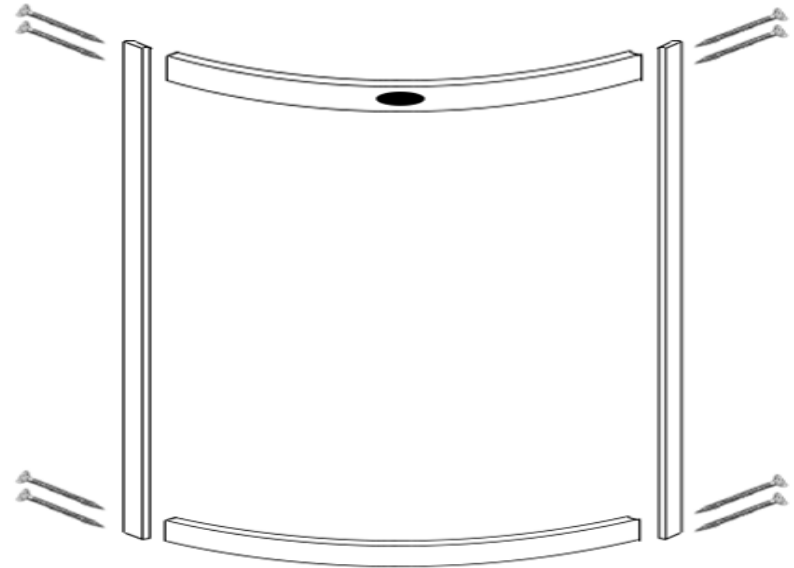

Step 3

Take the 2 front glass panels and lay them down gently. Now attach the “U” shape rubber seal to one side of each panel and cut off any excess.

Step 4

Now push the front fixed glass into the frames in the direction as shown by the below arrows and then fix into place using the **PRC20** securing clips and **ST12** screws

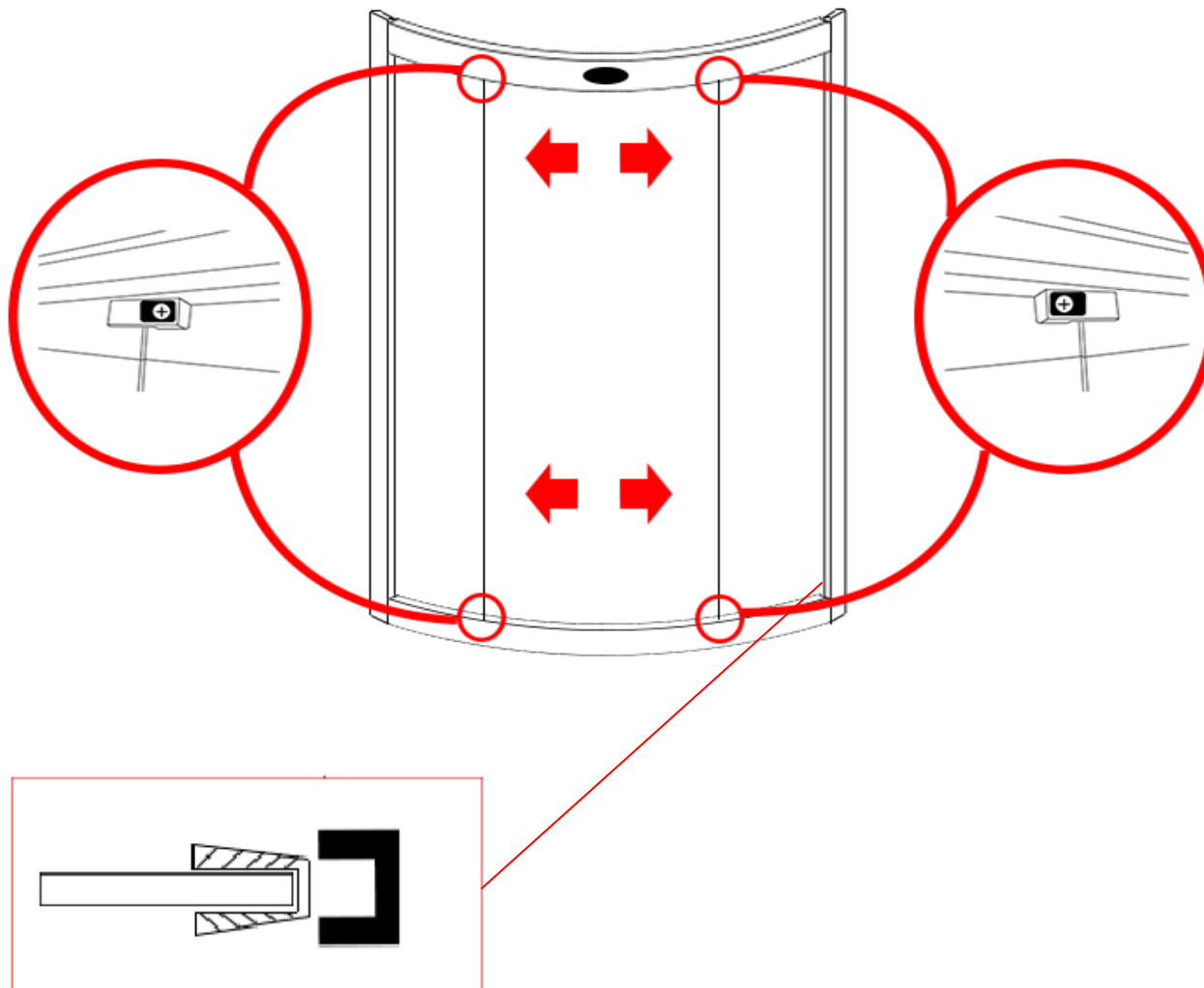
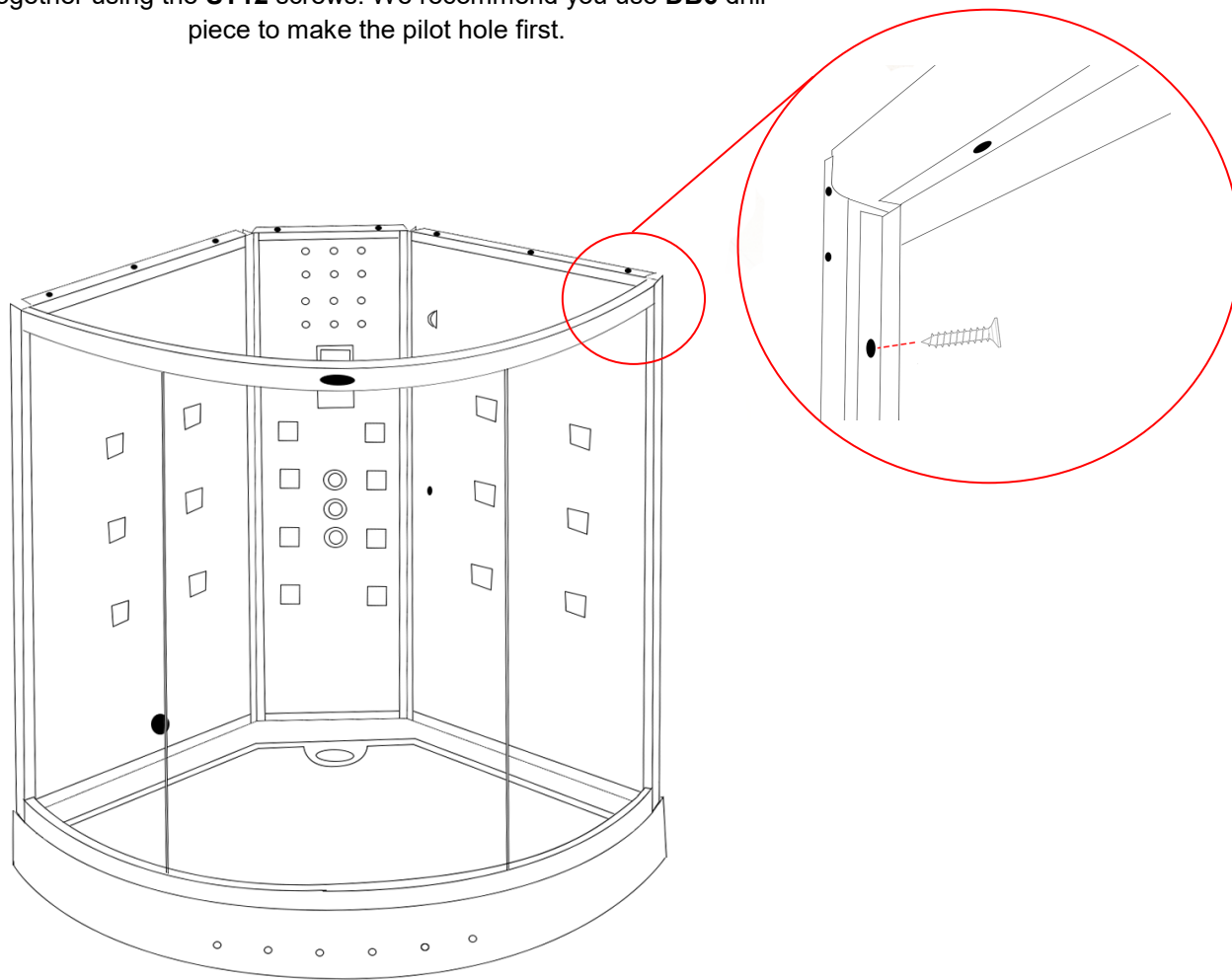

Image showing rubber seal on glass before being inserted into position into the frame

Step 5

Take the front frame and meet this to the back panels and screw together using the **ST12** screws. We recommend you use **DB6** drill piece to make the pilot hole first.



Step 6

Align the roof on to the top of the shower but **DO NOT** screw into position yet.

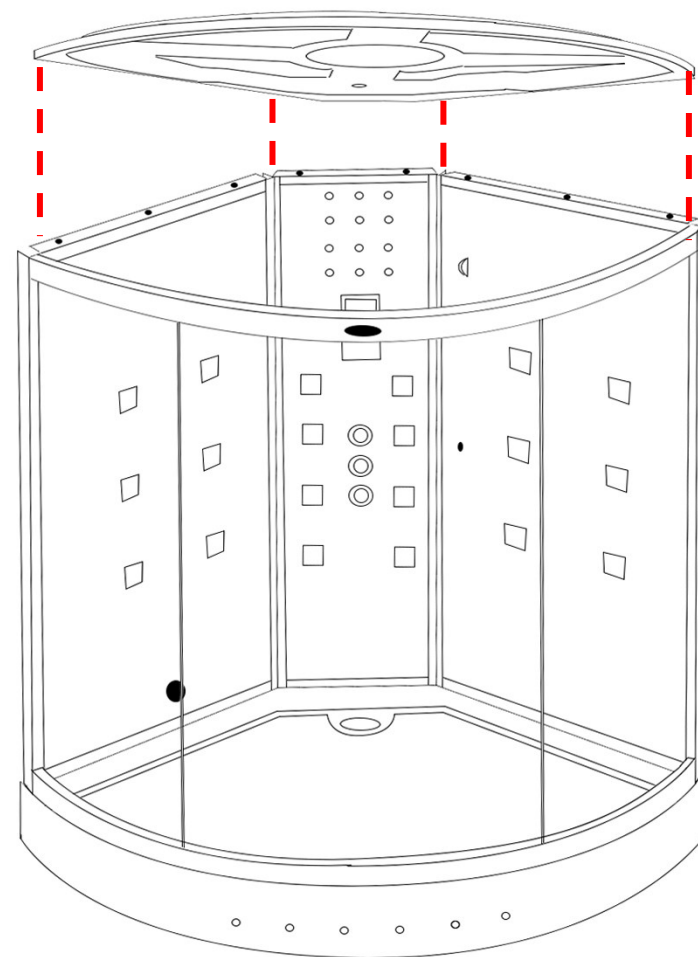

Step 7

Align the back panels to the contour of the tray and the roof and once your happy everything is perfectly aligned screw the tray to the back panel using **ST12** screws and **SW9** washers

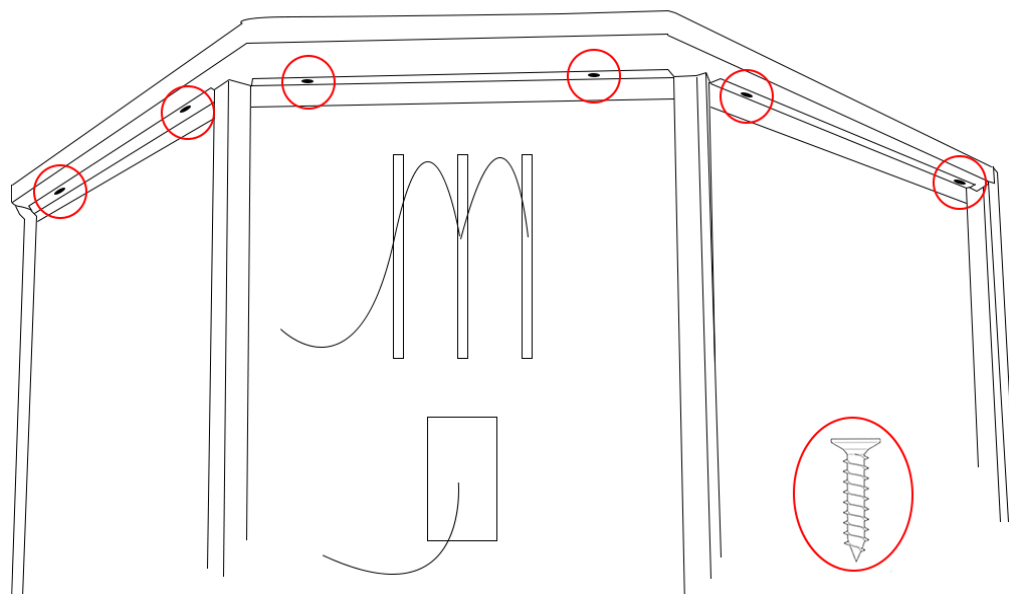
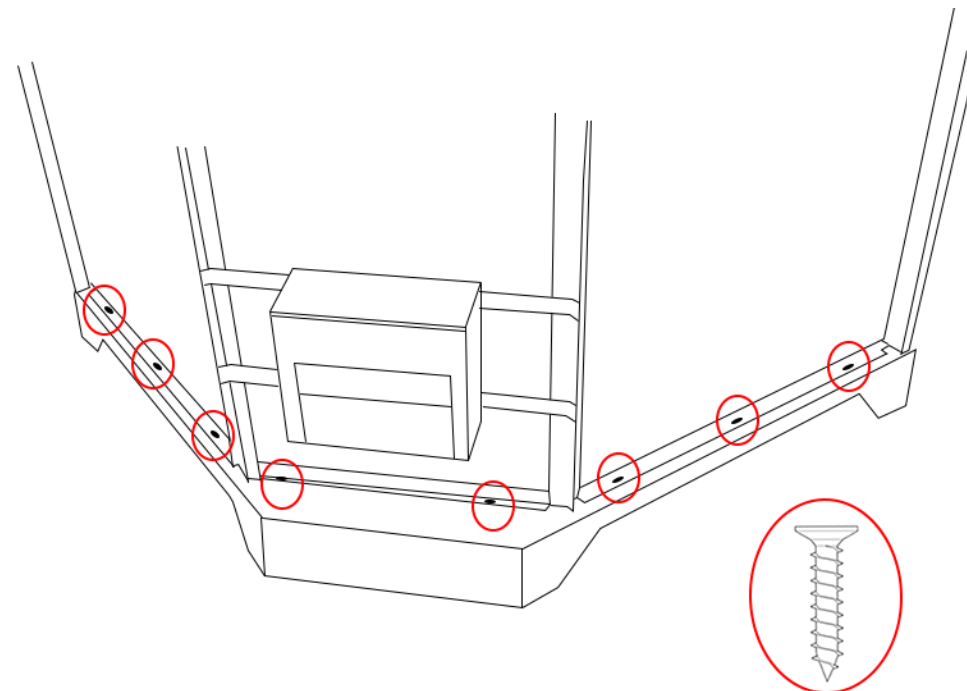

Step 8

Now the base is securely in position you can attach the roof. Using the **ST12** screws and **SW9** Washers connect the back panels to the roof.

NOTE: If a small gap exists silicone seal later.

Step 9

Taking the left and right hand doors insert the wheels to the top and bottom of each door. Ensure the double wheels fix to the top of the door and the single push button to the bottom. To secure in to place simply unscrew the bolt at the back of the wheel and prise apart the wheel. Push the wheel over the bottom/top of the door and re-attach the bolt.

To hang the doors, **carefully** carry the door in to the shower and hang the top wheels on to the track. Next de-press the buttons on the bottom wheels until the wheel falls in to the rail. Do this for both doors the close them up together. It will be more than likely the doors wont meet correctly at this stage, therefore adjust the top wheels by the screw underneath the wheel up or down by screwing clockwise/anti-clockwise until the doors meet perfectly.

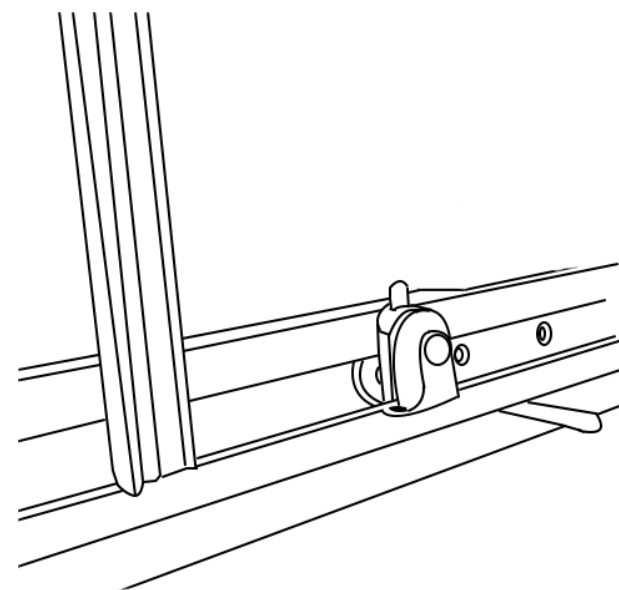
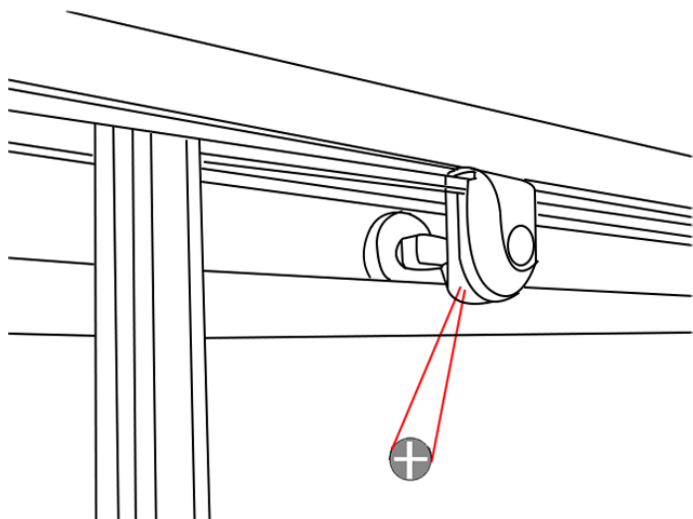

Handles

Ensuring that the inner thread is protruding out from the handle far enough, place the handle on the outside of the door and secure by tightening the inner chrome knob to the protruding inner thread

Magnetic Seals (If not fitted)

Push the magnetic door seal on the handle side of the glass door ensuring this is tightly fitted.

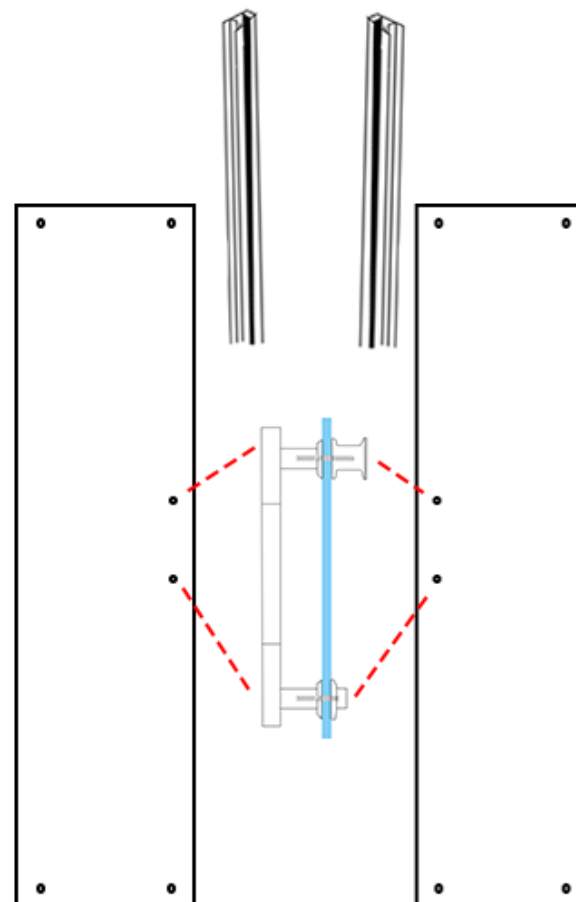
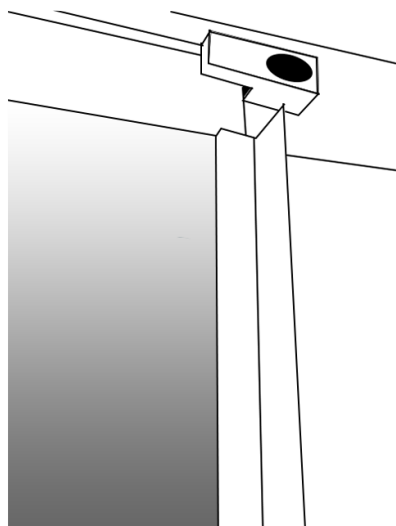

Door Seals

Place the rear door seals on the outer edge of each of the front glass panels as shown on the image on the left hand side.

Accessory Installation

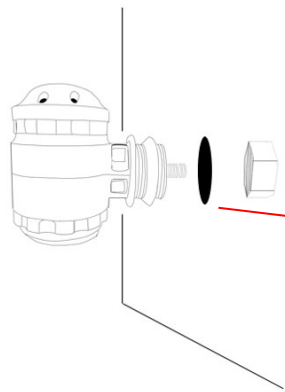

Steam Pod

Insert the pod from the inside of the shower and attach large white nut from the rear.

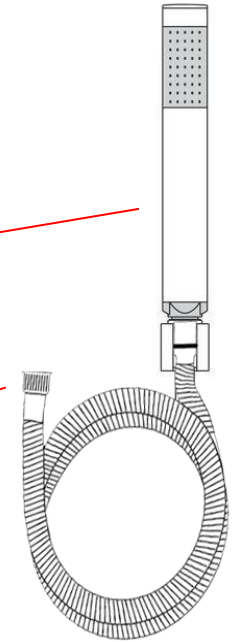
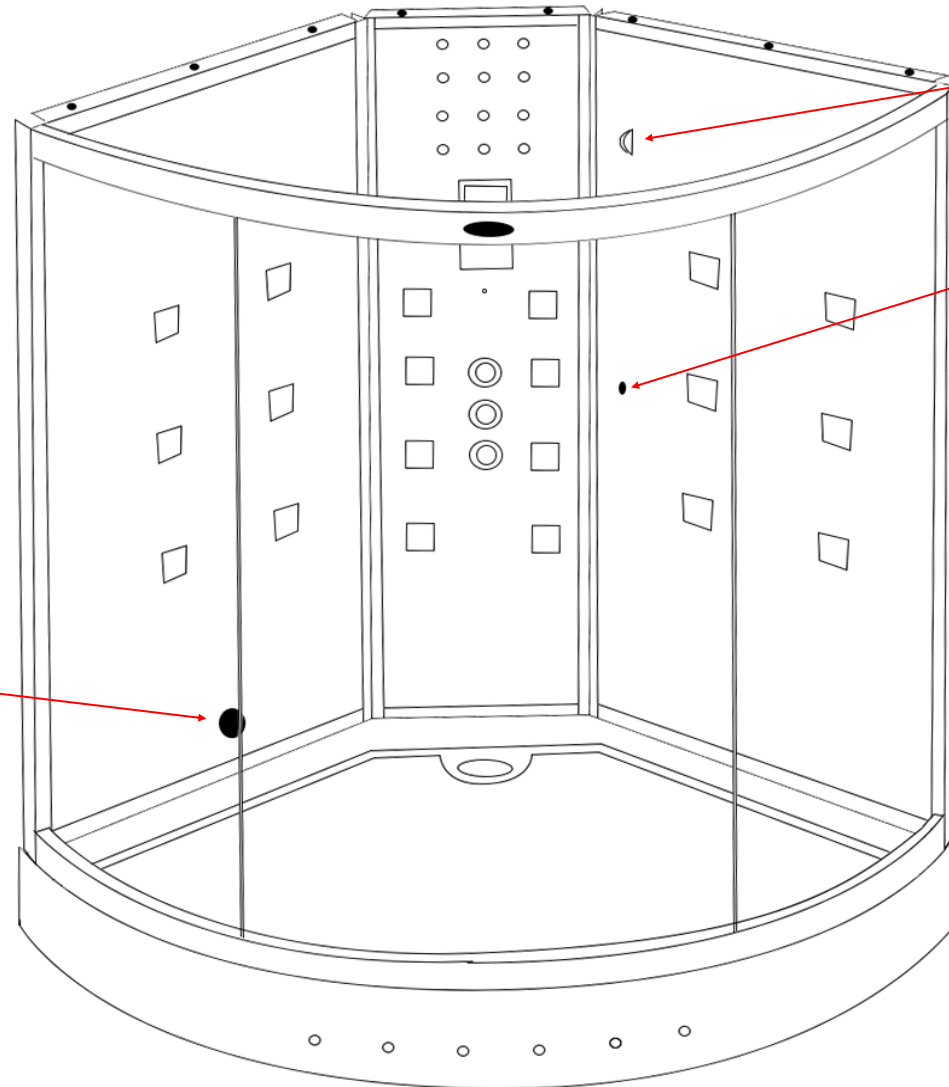

Hand Shower

1. Attach the chrome holder to the back wall via the 2 screws provided in the pack. In some cases this maybe pre-fitted to the back wall.
2. Attach the chrome water outlet to the back of the centre column, fixing it from the rear with the hex nut. Again this maybe pre-fitted.
3. Attach the chrome flexible hose to the water outlet with the small coupling end
4. Attach the other end (sleeved) to the hand shower and place in to the holder.

NOTE: If you attach the wrong end of the hose to the hand shower it will not sit in the holder.

Ozone (o3)

Unscrew the chrome pepper pot end and drop the white box upside down into the rear hole as shown in the image. Now from the inside of the shower re-attach the chrome pepper pot end and tighten.

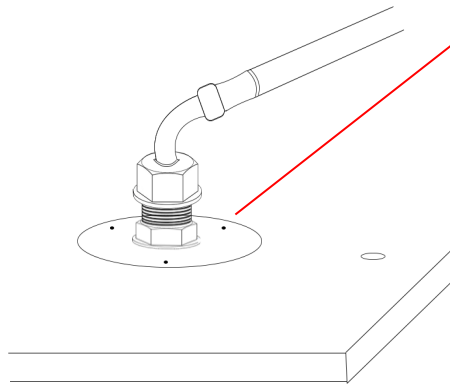
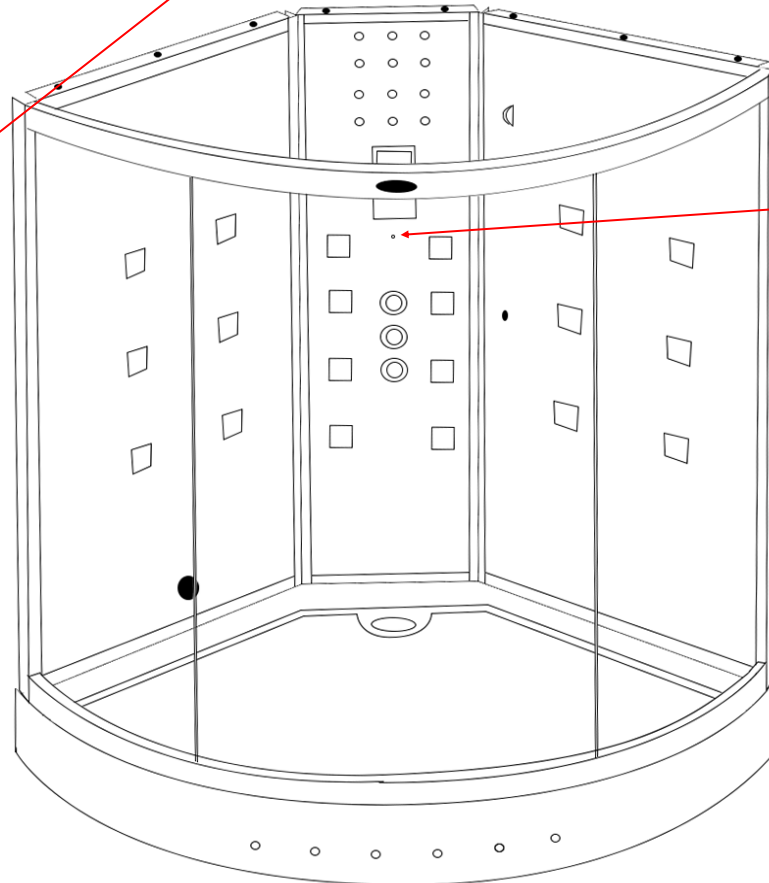
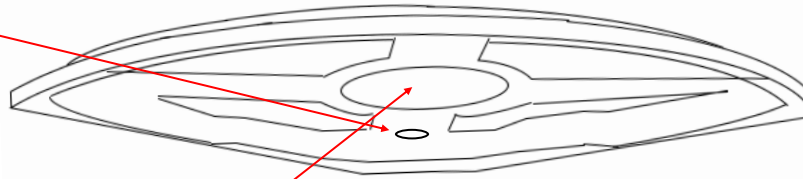
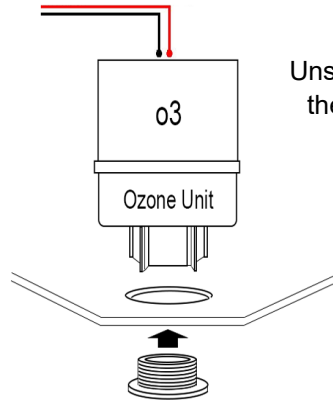

Monsoon Head

Screw the threaded tube in to the top of the monsoon shower head and pass it up through the light diffuser and through the hole in the shower roof. Secure in to position with the hex nut. Next Attach the grey hose from your shower valve to the threaded tube using PTFE tape (please note this only needs to be hand tight. Over tightening will snap/damage the tube)

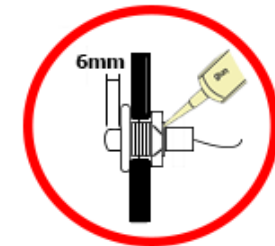
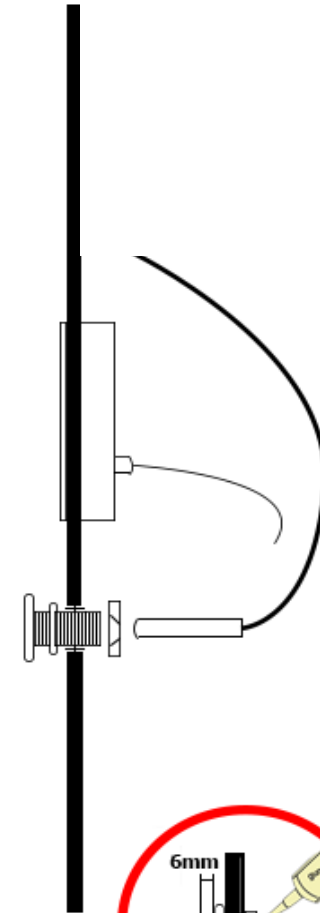

Thermostatic Probe

Insert the probe into the hole situated below the control panel roughly 6mm into the cabin and run clear silicone around the rear side of the probe

Shower Valve

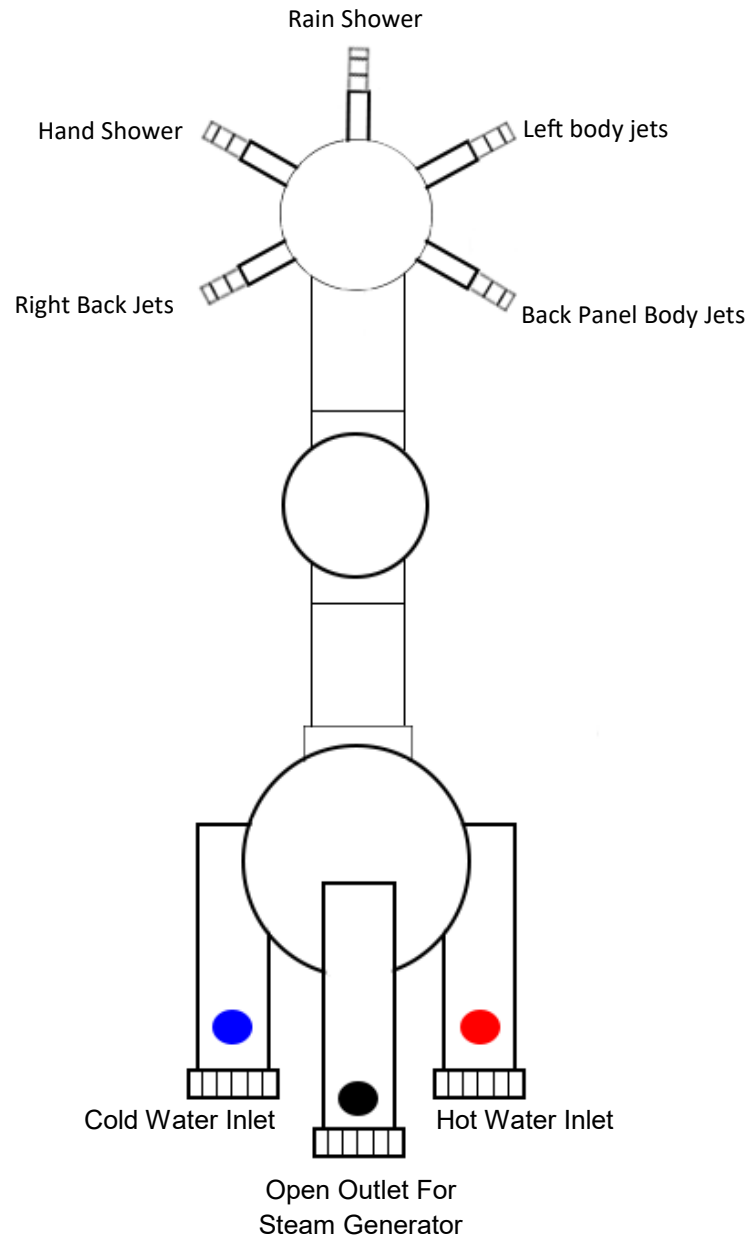

Shower Valve

Connect the hoses to the corresponding inlets on the back of the shower.

Device output may differ from the image. Please refer to your outer chrome faceplate inside your Insignia shower as a reference point.

IF YOUR DIAL DOES NOT CORRESPOND TO THE APPROPRIATE DEVICE:

Turn on your water to the shower and note which output the water exits from then turn off the water and swap over the relevant hose.

Alternatively remove the outer chrome knob by removing the chrome cap and loosening the grub screw (please ensure not to unscrew fully as this will drop within the chrome knob) this is found on the opposite side to the chrome pillar. Once you have succeeded in loosening this you can now slide your faceplate to correspond to the device.

Electric Box/Steam Generator Connections

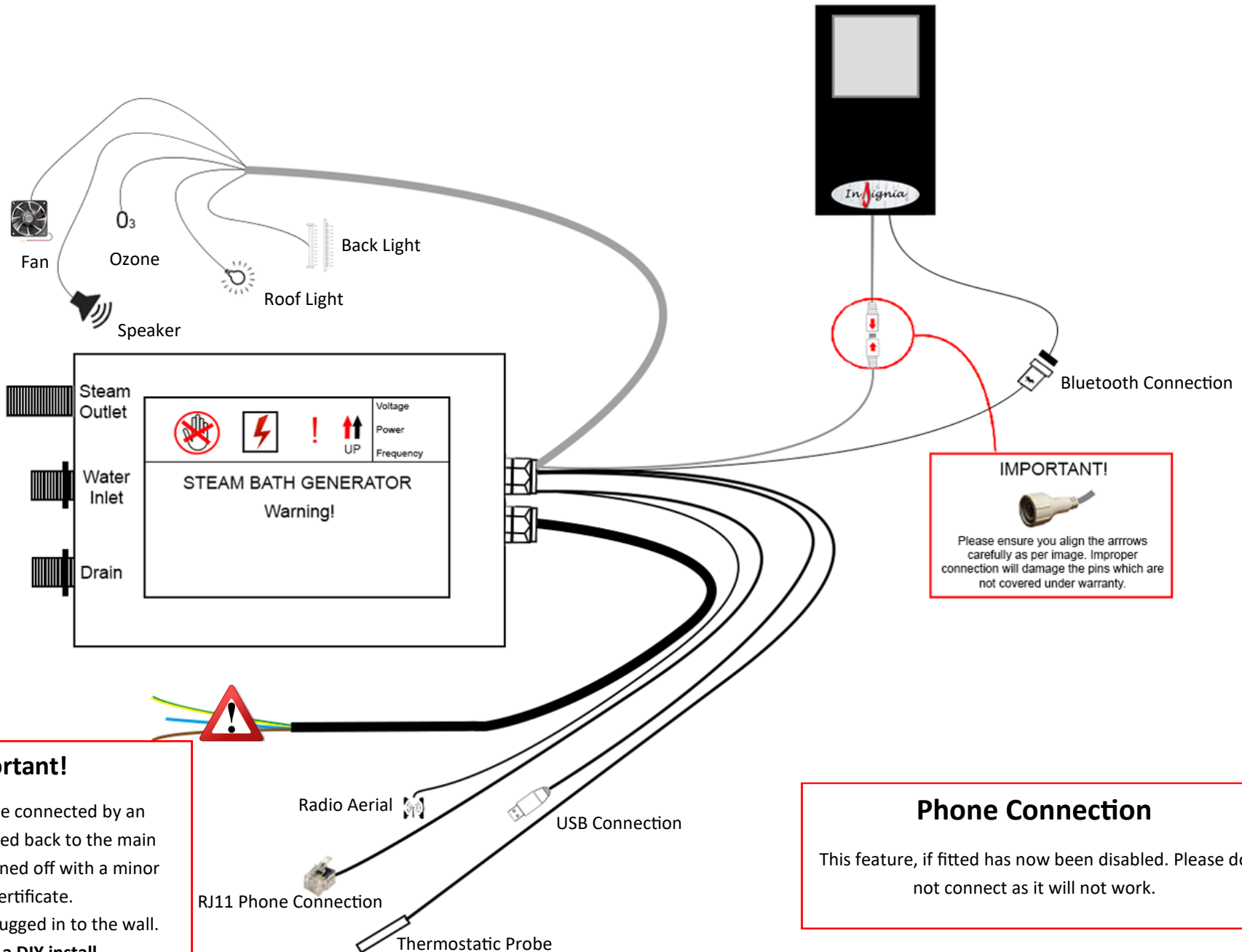

Important!

This unit **MUST** be connected by an electrician and wired back to the main service box and signed off with a minor works certificate. This can **NOT** be plugged in to the wall. **This is NOT a DIY install.**

IMPORTANT!



Please ensure you align the arrows carefully as per image. Improper connection will damage the pins which are not covered under warranty.

Phone Connection

This feature, if fitted has now been disabled. Please do not connect as it will not work.

Connection For Tray & Column Lights

Using the supplied extension lead, please connect the end with the single connection to your tub lights. Next bring the extension lead up the back of the shower and connect one of the plugs to the column lights (essentially bridging the two sets of lights together)

Now with the remaining connection, connect this into the wire coming from the electric box with the column light sticker on (as shown in the image)

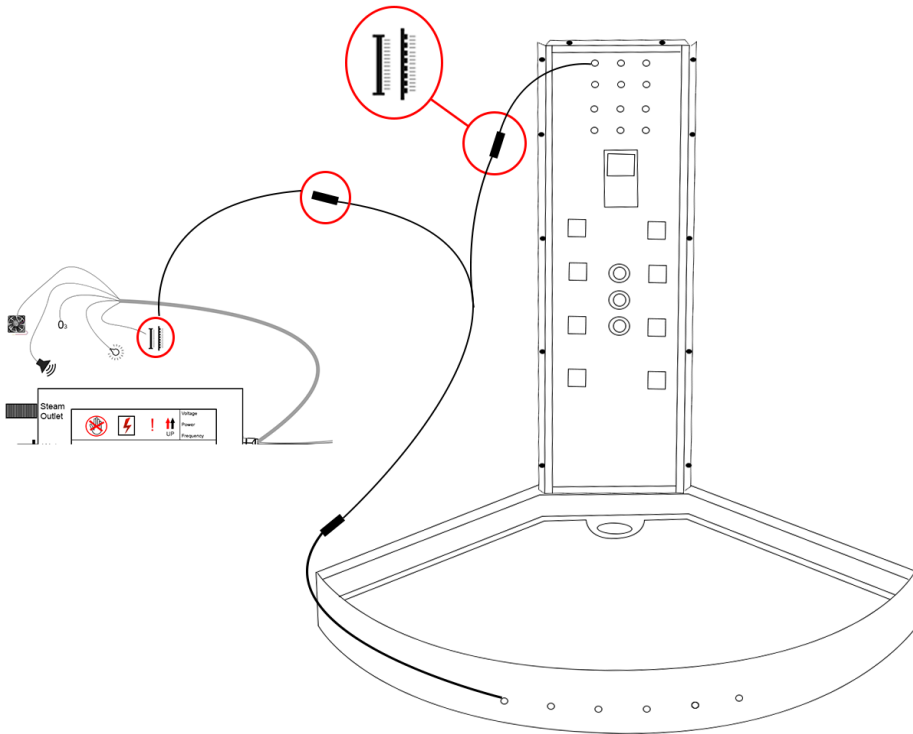

Safety precautions

Never leave children unattended in the shower or bath.

Never bath children (under 12) using whirlpool function if fitted.

Regulate the temperature of water before showering

Never allow children to use the steam function. This function is for
ADULTS ONLY.

Always be aware of the steam outlet pod position. Never use in close proximity to the person using it.

Never use this shower if you have been drinking alcohol.

Never use with more than one person unless the shower is designed for this.

This product is not to be used for washing/bathing animals

Steam Generator Connections

The steam generator has 3 connections.

Steam Outlet: Connect the white insulated hose to the white steam pod within your shower. Make sure these are fitted in the correct position as they are only attached for transportation reasons only.

Water Inlet: Connect a braided hose from the shower valve's centre feed to this opening.

Drain: Connect the grey rubber hose from the steam generators drain opening to the nozzle on the shower waste (as shown in the below image)

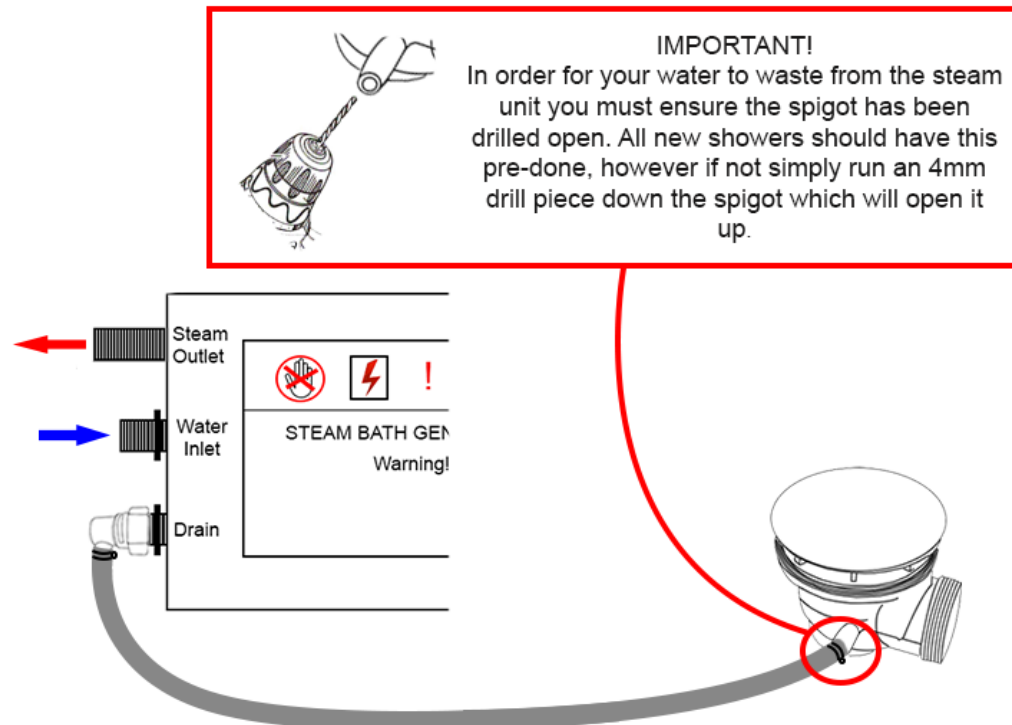

Silicone Seal where shown in red on the inside of the shower

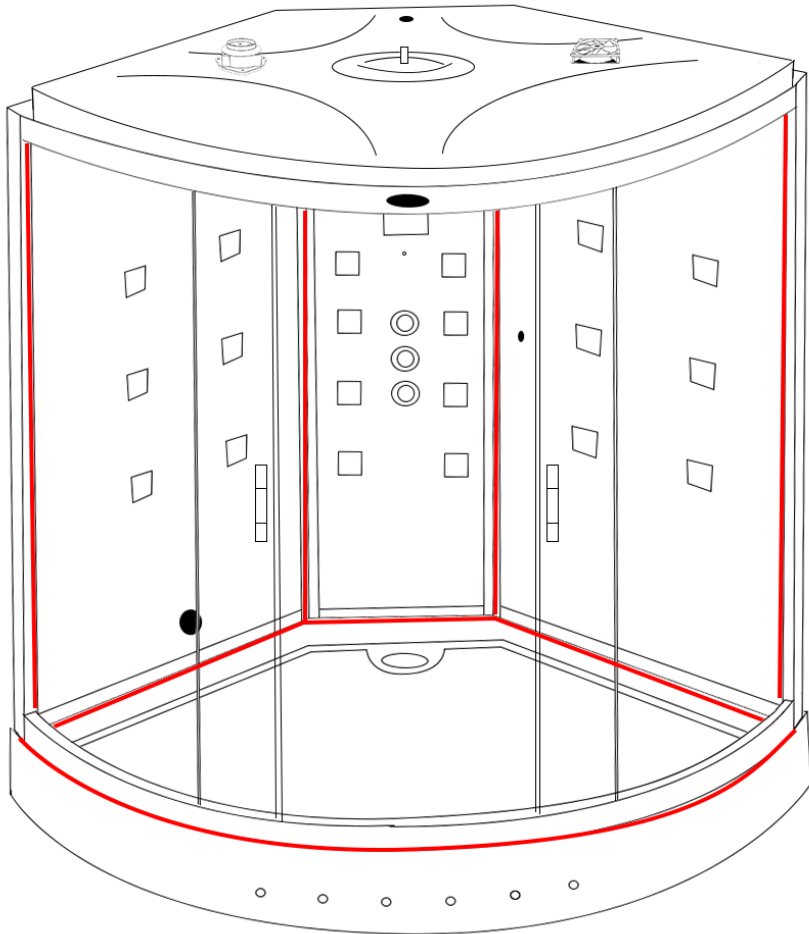

TESTING FOR WATER LEAKS

LEAVING SHOWER 24 HOURS AFTER BUILD ALLOWING SEALANT TO CURE

With all connections tight, the waste and hoses checked, jets fully sealed, your shower still around 18 inches from its designated final resting point and the silicone fully cured (hence leaving for 24 hours minimum) Switch on the overhead shower NOT the massage jets, remember these will fire water out at you and are not suitable for checking leaks as they would normally only operate when a person is in front of them. Just use COLD water setting as hot will make cabin misty and condensate thus the inspection becomes very difficult. Now on the OUTSIDE of the shower inspect each joint, factory seal, hose, clip and jet by walking from one side and going around to the back and then to the other side finishing at the front. If you have a small leak (normally caused through insufficient sealer or air bubble on assembly, dry the area thoroughly and reseal on the OUTSIDE. Please remember where you see the water this may not be exactly where the leak is as it could have run around to a low point. Never seal your inner fittings (accessories) inside unless you feel it necessary and make sure it is thin and neat, remember you will see this for the life of the shower! Again leave to cure and check. If all good now check shower functions i.e. jets for back massage, and hand shower, check your joints to these functions at the rear again. Never use the shower until **all** checks have been made and the installer is 100% happy in the knowledge no leaks are present.

All good?

Now push your shower FROM THE BASE NEVER GLASS OR FRAME into its final resting position.

Now you can shower in the knowledge that you have no leaks a job done well and long product life.

Happy showering!

Note: In some cases it may be prudent to add silicone around the rear base of the shower to add extra water proofing and integrity to the build.

MK117U Control Panel Instructions

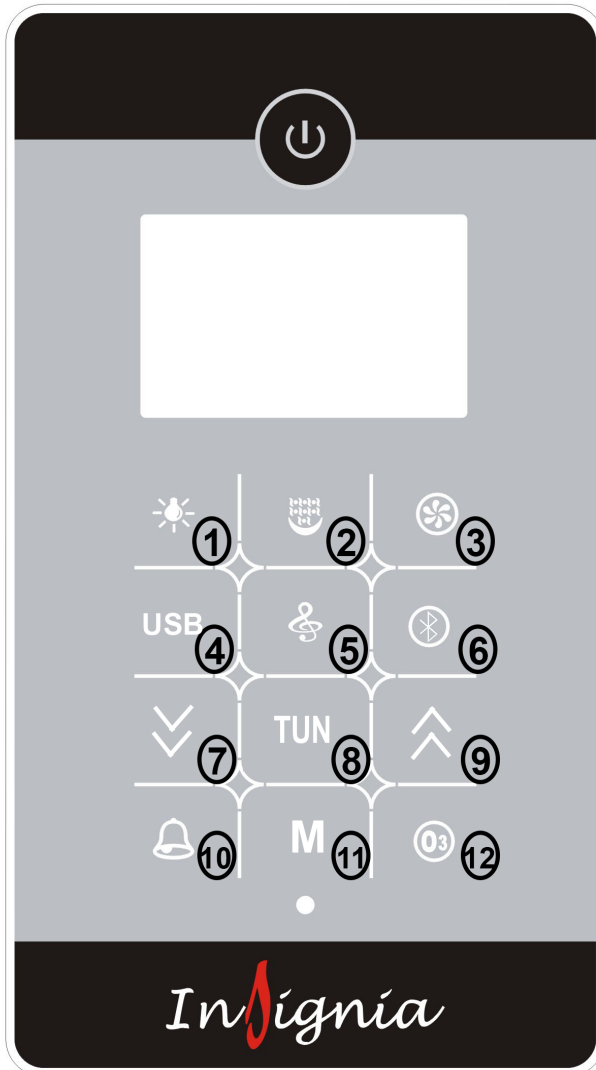

*When loading music on to your memory device the play order will be ordered based on the date the files were created.

Button 1 (Light Bulb)

Press x1 backlights

Press x2 Operates the tray lights

Press 3x For All Lights

Press 4x To Switch Off Lights

Button 2 (Steam)

On/Off

Button 3 (Fan)

On/Off

Button 4 (USB)*

Connect an external memory device and use the button 7&9 for forward and backward operation

Button 5 (Radio)

On

Button 6 (Bluetooth)

On/Off (When activated a beep will sound and the power button will flash purple to notify you that the Bluetooth is searching for a device. Power button will be fixed purple when paired with a device. To pair another device to your control panel, reset the control panel by powering off and powering back on and please ensure you have switch off the Bluetooth to any current paired devices as only one connection can occur at any one time..

Note: The device you are looking to pair is either "INSIGNIA" or SPR-OUT"

Button 7 (Down Arrow)

Channel select down/manual search

Button 8 (TUN)

Switch Between manual & auto radio searching

Button 9 (Up Arrow)

Channel select up/manual search up

Button 10 (Alarm)

Activate Alarm

Button 11 (M)

Set Steam Time & Temperature/When Radio is active this button will activate the arrows to become volume buttons

Button 12 (o3)

Press to activate once you finish using the shower

Power Button (Lock)

The control panel will automatically lock when not in use for a short time, hold this button down for 3 seconds until a beep is heard and this will unlock and re-activate the control panel for use

Need Help?

Then simply download the following "Help" advice booklet found at this link below. This contains many useful items such as is your parts warranty registered, advice on cleaning / servicing your shower cabin, fault finding and many more items. This is a **MUST** to read and not just "HELP". It saves time in nearly all cases, avoiding contact with ourselves as most answers are there for a ready fix!

Simply visit: www.insigniarange.co.uk/help.aspx



INSIGNIA PRODUCTS
HELP I HAVE PROBLEMS AND
NEED ANSWERS NOW!



PLEASE KEEP IN SAFE PLACE

www.insigniarange.co.uk

Parts List

Internal Items

Part Code	Part Description
SP074	Monsoon Shower head
SP056	Ozone Module
	Roof Lights
SP226	Massage jets
SP103	Hand Shower Holder Chrome water outlet
SP159	Shower waste
SP097	Chrome rectangular door handles
SP013	Skirt light
SP196	Thermo sensor holder
SP072	Door stoppers
SP106	Door Wheels
SP006	Steam Pod
SP105	Chrome Flexible Hose
SP060	Electrical extension cable
SP197	Column lights
SP038	Speaker
SP007	Fan
SP037	Fan & speaker cover

SP204	MK117U Control panel
SP254	Blister pack
SP227	Standard shower head
Sp166	Approximately 4 meters of "U Style" seals

External Items

Part Code	Part Description
SP300	Waste hose
SP301	White insulated pipe
SP221	Drain Hose
	4.5 Steam Generator/ Electric box
SP307	Magnetic door seals
SP310	Rear door seals
SP155	5 Port—3 Feed Thermo- static valve

Framework

Part Code	Part Description
GT7000-13	Bottom Rail
GT7000-12	Top rail
GT7000-4	Left upright
GTT7000-5	Right upright
GT7000-1	Tray
GT7000-7	Blank roof
GT7000-3	Blank column

Glass

Part Code	Part Description
GT7000-8	Glass door (universal)
GT7000-11	Right Backwall
GT7000-10	Left Backwall
GT7000-9	Front fixed glass (universal)

All images are registered with
ImageTraker

Insignia™ is a registered trademark of Maclean International Ltd

All images are subject to copyright. Images may not be used in any way shape or form with out written permission from Maclean International Ltd. Images are NOT permitted to be saved, printed or uploaded. Violation of copyright laws are punishable by law.